

ROCKMAX[®] SWELLING 101

HYDROPHILIC SWELLING WATERSTOP



INTRODUCTION

Rockmax Swelling 101 is a hydrophilic swelling waterstop. The based material is bentonite clay with polymer rubber. The product swell when contact with water create more than 300% expansion. The release bentonite fill void between the two portions of concrete joint.



AREA OF USES

- Construction joints.
- Water tank, waste water tank.
- Tunnels.
- Basements.
- Elevator pits.
- Retaining walls.
- Pipe penetration.
- King post.
- Sheet pile joint.
- Precast concrete structure.
- Block out.
- Pile cap.

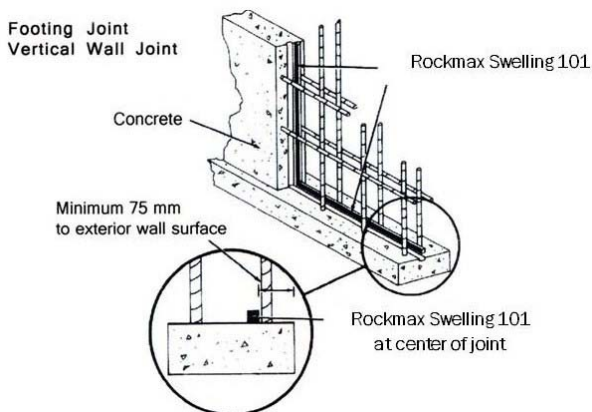

ADVANTAGES

- Withstand hydrostatic pressure (>70m).
- Can use in portable water tanks.
- Fast and easy installation.
- Fast track project.
- Easy to joining.
- Durability.
- Economical.
- Easy to transport.

- No packing effect.
- Non toxic.

TECHNICAL PROPERTIES

Color:	Black
Base material:	Bentonite & rubber
Specific gravity:	1.60-1.70
Shore A hardness:	15 - 20
Hydrostatic pressure resistance:	>70 meter
Adhesion to concrete:	Excellent
Wet/dry cycle:	No effect
Expansion rate:	>300%
Elongation:	approx 200%
Tensile strength:	>0.5 N/mm ²
Glue type:	Rockmax Adhesive 11
Services temperature:	-25°C to +85°C
Application temperature:	+5°C to +45°C

PREPARATION

Concrete substrate must be clean, free from oil, grease, mould oil, dust and other loose particles. Ensure there is no crack on concrete surface. Damaged concrete must be repair prior to install **Rockmax Swelling 101**.

APPLICATION

Apply **Rockmax Adhesive 11** (adhesive) along the concrete construction joint. Wait approximate 10-15 minutes see the adhesive look tacky. Release paper of **Rockmax Swelling 101** and press firmly on the concrete surface. **Rockmax Swelling 101** can use together with nail. Make sure profile is attached to the concrete surface. Use butt joint for joining waterstop. Make sure the joint is firm and attached the concrete surface.

In case of water and rain environment, Apply **Rockmax Swelling Delay** after install **Rockmax Swelling 101** immediately. **Rockmax swelling Delay** will protect the expansion rate from water and rain.

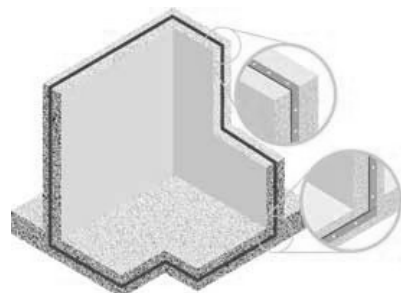

ROCKMAX[®] SWELLING 101

HYDROPHILIC SWELLING WATERSTOP



TYPICAL DETAIL DRAWING



Rockmax Swelling 101 at steel king post

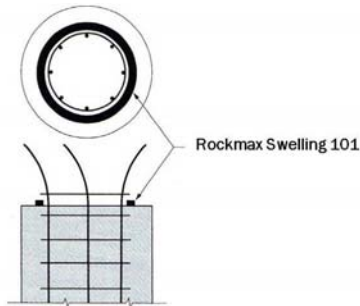

Rockmax Swelling 101 at pile cap

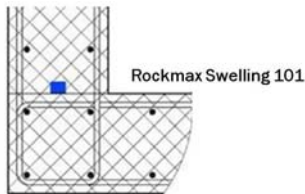

Rockmax Swelling 101 at construction joints

CLEANING

Clean all tools and equipments immediately with water.

LIMITATIONS

- **Rockmax Swelling 101** can not use for expansion joints.
- Need at least 80mm concrete cover.
- Not applicable in high degree of salt water.

PACKAGING

25mm x 20mm x 5meter (30 Meter/box)

20mm x 15mm x 6meter (36 Meter/box)

20mm x 10mm x 9meter (54 Meter/box)

STORAGE

Storage in shade and dry condition. Avoid from frost, water, moisture and high temperature.

SHELF LIFE

18 months if kept follow instructions.

PRECAUTIONS

Rockmax Swelling 101 is not hazardous during normal condition use. It is recommended to take the safety standard and precaution for application and storage.

CONTACT DETAIL

THAILAND

Rockmax Company Limited

T: +66 2 8648658

F: +66 2 4184327

E: info@rockmax.net

W: www.rockmax.net

VIETNAM

Viet Dai Viet Chemical Company Limited

T: +84 86 2615184

F: +84 86 2615185

E: rockmaxvn@gmail.com

IMPORTANT NOTE!!

The technical information contained herein, while not guaranty, was prepared and approved by technical personnel and is true, accurate to the best of our knowledge. No warranty or guaranty is made regarding performance, stability or other factors beyond our control. Rockmax will welcome to be consultation of our performance and application. This technical datasheet supersedes and issue new edition without prior notice.

 Printed on recycled paper
Copyright©2013 Rockmax